

# Explorer™ TV Accessory – Directional Locks

## Assembly Instructions

Model: ETCPRMDL

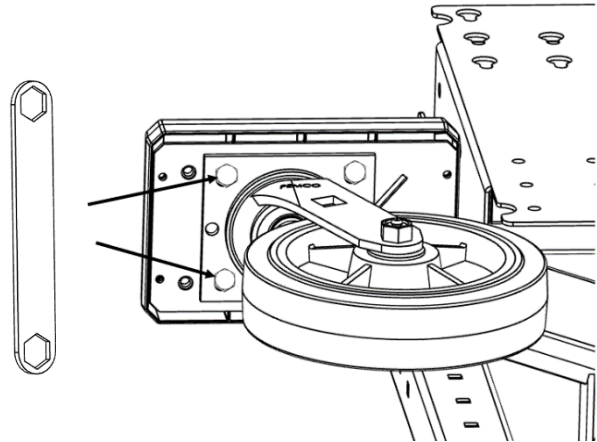
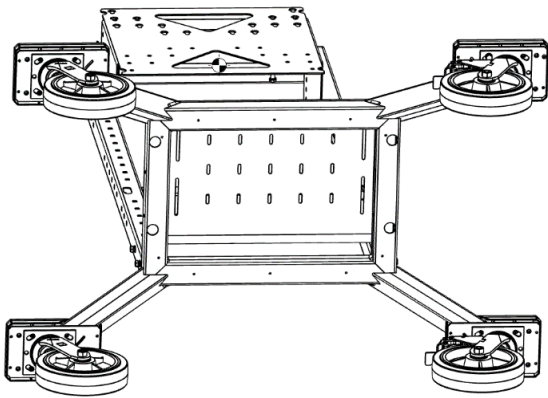
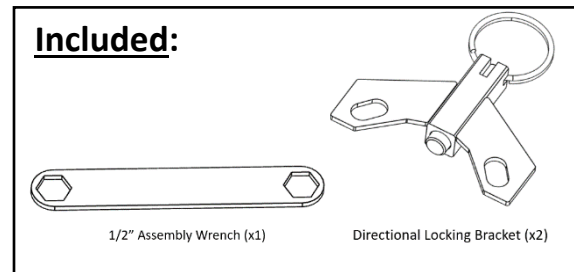

1. If purchased separately, remove TV from your Explorer TV Cart and lay it on its back.
2. On the swivel caster side, use the wrench to remove the screws and washers above.

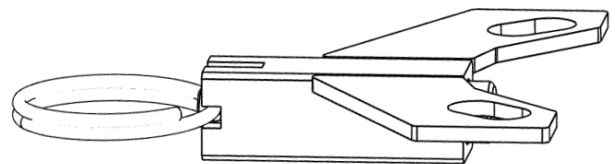
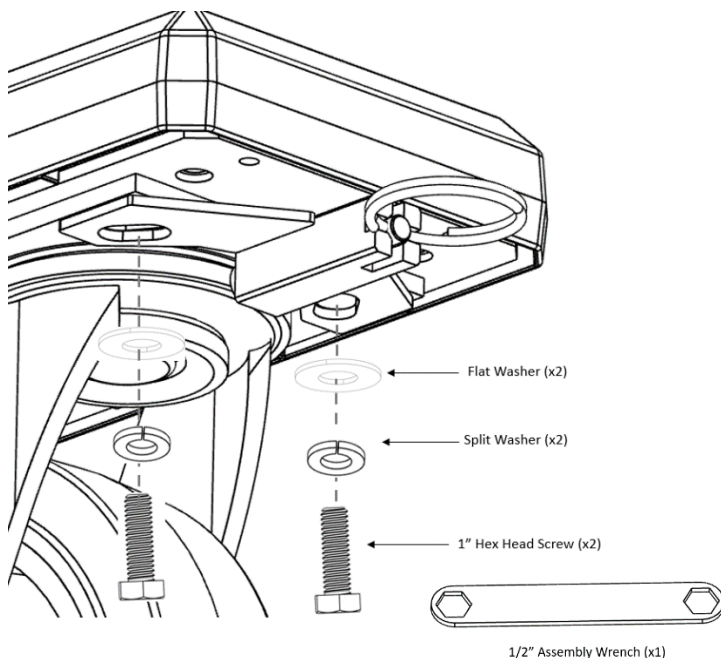

Swivel

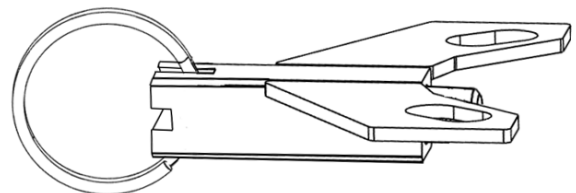

Direction Locked

3. Add the directional locking brackets, attach with removed washers and screws, then tighten with wrench.
4. To lock the caster directionally, pull the tab out of the shallow slot, turn 90 degrees, and slide into the deep slot.